

RAY CORE INC.
ENERGY SAVING ROOF WALL & HEADER SYSTEMS
 www.raycore.com
 305 East Elva Street • Idaho Falls, Idaho 83401
 877.552.2440 • info@raycore.com
 Permission granted for RAY-CORE projects only.
 © RAY-CORE, INC.

DETAIL NO. SF_R1_RAYCORE eave as struct rafters-CAN-v2
 BY KPL/Alpen Engineering, Inc.
 DATE 2/26/18
 REVISION DATE _____

STRUCTURAL DETAIL

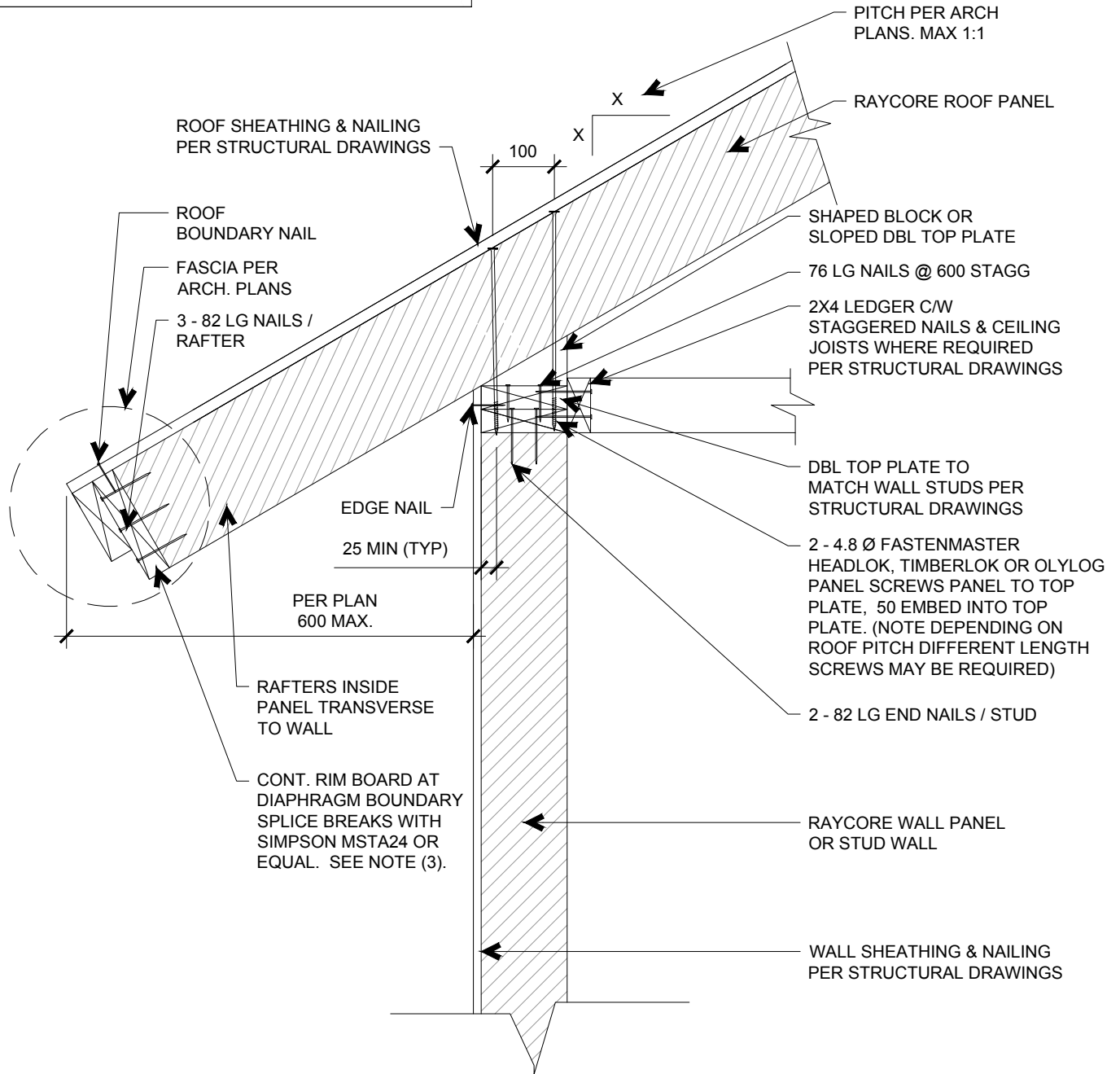

R1

RAYCORE AS STRUCTURAL RAFTERS AT EAVE

SCALE: 1:10

SF_R1_RAYCORE eave as struct rafters-CAN-v2

NOTE:
 (1) ALL DIMENSIONS ARE IN mm UNLESS NOTED OTHERWISE
 (2) DETAIL APPLIES TO 2X6 OR WIDER WALLS. FOR 2X4 WALLS, NEED ENGINEERED CONNECTION BETWEEN RAYCORE ROOF PANEL & TOP PLATE
 (3) RIMBOARD MATERIAL TO MATCH RAFTERS INSIDE RAYCORE PANEL FOR SHRINKAGE COMPATIBILITY.