

**RAY CORE INC.**  
**ENERGY SAVING ROOF WALL & HEADER SYSTEMS**  
 www.raycore.com  
 305 East Elva Street • Idaho Falls, Idaho 83401  
 877.552.2440 • info@raycore.com  
 Permission granted for RAY-CORE projects only.  
 © RAY-CORE, INC.

DETAIL NO. SF\_R4\_Raycore at gable wall w ladder fr-CAN  
 BY KPL/Alpen Engineering, Inc.  
 DATE 2/26/18  
 REVISION DATE \_\_\_\_\_

*STRUCTURAL DETAIL*

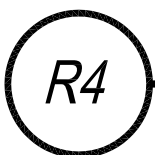
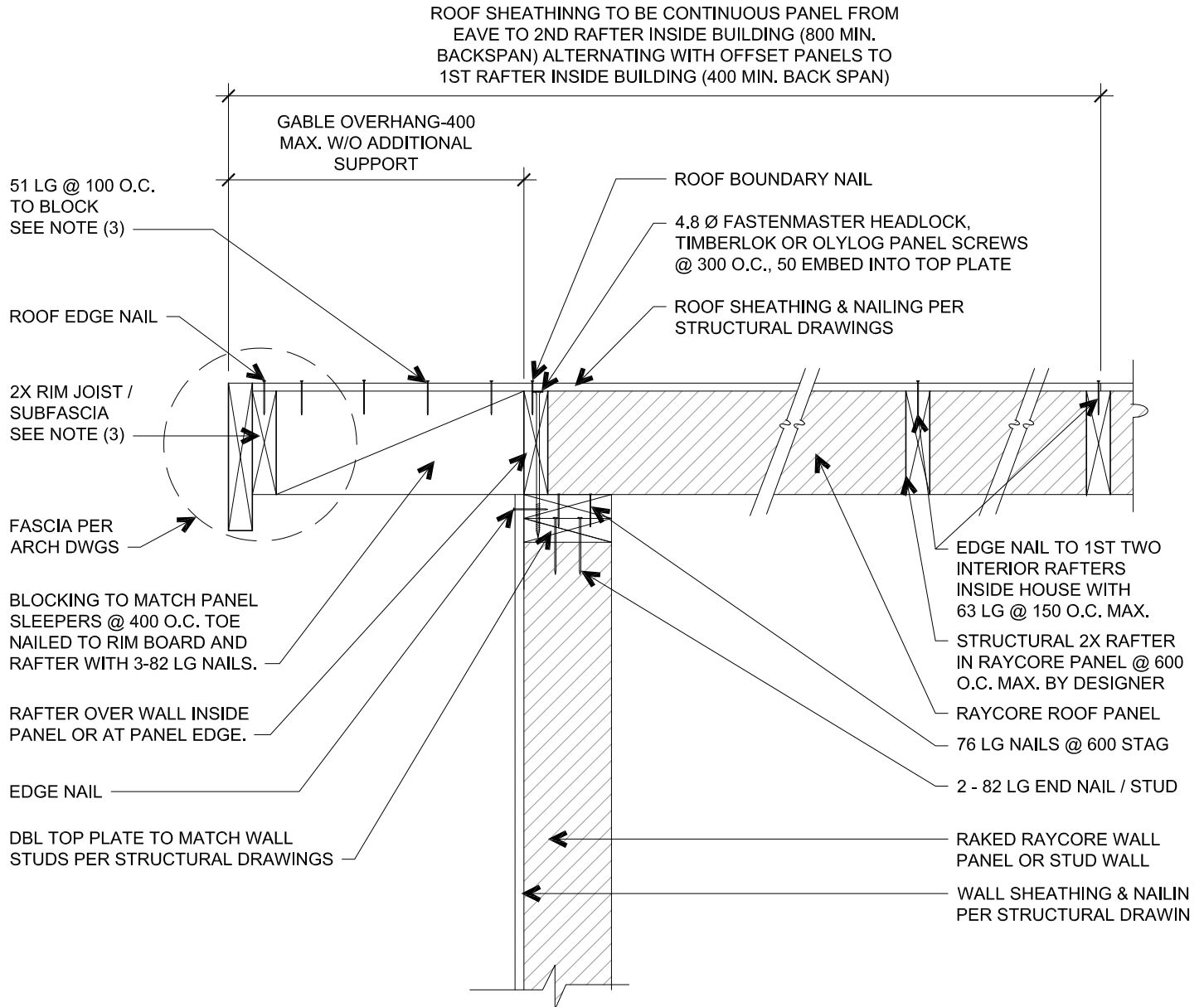

**RAYCORE AT GABLE WITH LADDER FRAMING**

SCALE: 1:10

SF\_R4\_Raycore at gable wall w ladder fr-CAN

NOTE:

(1) ALL DIMENSIONS ARE IN mm UNLESS NOTED OTHERWISE

(2) IF HWP > 0.8 kPA PROVIDE ADDITIONAL FASTENER. DESIGN TO RESIST FACTORED UPLIFT OF 3 kN

(3) EAVE OVERHANG FRAMING & CONNECTIONS TO BE DESIGNED BY DESIGNER OR ENGINEER FOR PROJECT SPECIFIC LOADING. DESIGNER OR ENGINEER TO CHECK WALL STUDS & FASTENERS FOR ADDITIONAL THRUST FROM OVERHANG FRAMING.