

**RAY CORE INC**  
**ENERGY SAVING ROOF WALL & HEADER SYSTEMS**  
 www.raycore.com  
 305 East Elva Street • Idaho Falls, Idaho 83401  
 877.552.2440 • info@raycore.com  
 Permission granted for RAY-CORE projects only.  
 © RAY-CORE, INC.

DETAIL NO. SF\_R15\_Raycore at Gambrel Pitch Break - US  
 BY KPL/Alpen Engineering, Inc.  
 DATE 2/26/18  
 REVISION DATE \_\_\_\_\_

*STRUCTURAL DETAIL*

2 - 3/16" FASTENMASTER HEADLOK TIMBERLOK OR OLYLOG PANEL SCREW @ EACH SLEEPER/RAFTER CONNECTION, MIN. 2" EMBED IN RAFTER, TYP

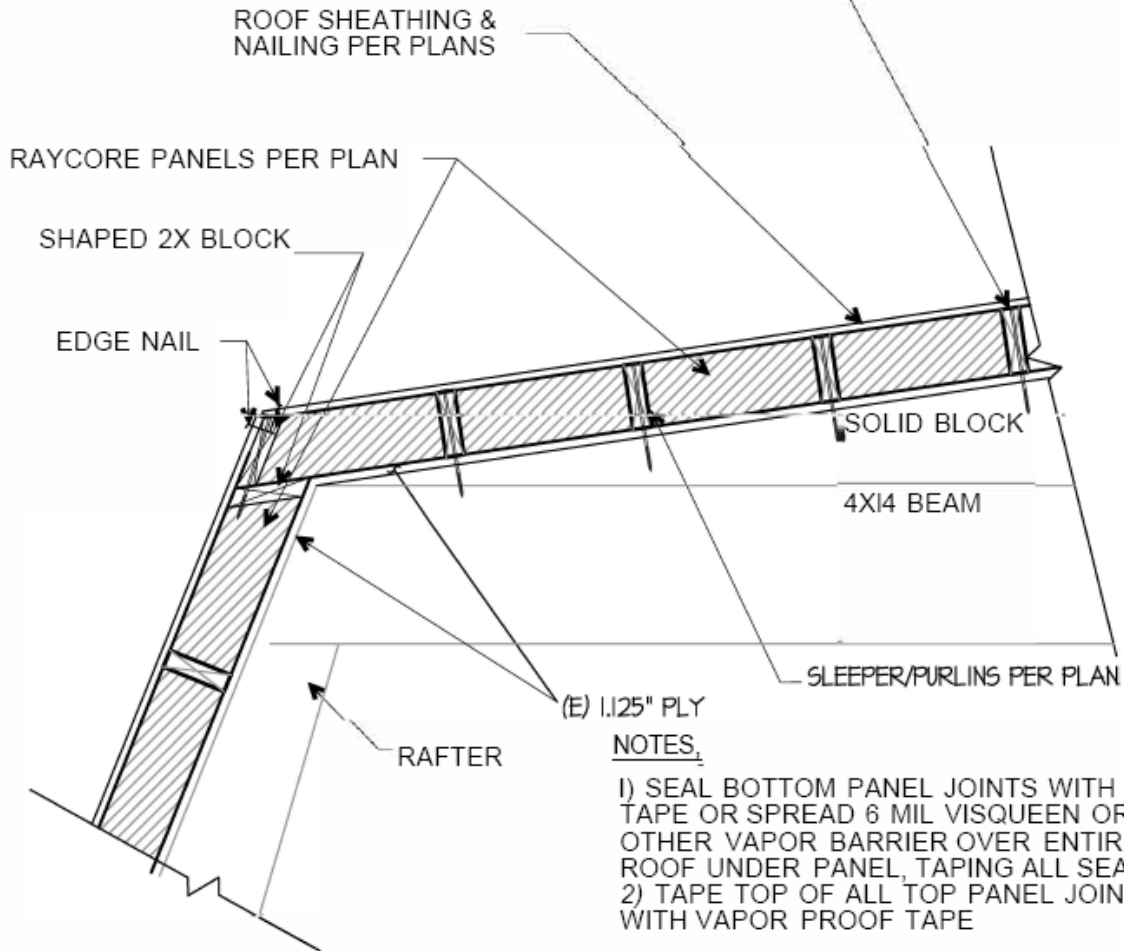

- NOTES**
- 1) SEAL BOTTOM PANEL JOINTS WITH 3" SIP TAPE OR SPREAD 6 MIL VISQUEEN OR OTHER VAPOR BARRIER OVER ENTIRE ROOF UNDER PANEL, TAPING ALL SEAMS
  - 2) TAPE TOP OF ALL TOP PANEL JOINTS WITH VAPOR PROOF TAPE

**R 15**

**RAYCORE AT GAMBREL PITCH BREAK**

SCALE: 3/4" = 1'-0"  
 NOTE:  
 (1) ALL DIMENSIONS ARE IN INCH UNLESS NOTED OTHERWISE

SF\_R15\_RAYCORE at gambrel ptch br 1--11.125 pl - US